





13 801 670

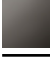

- 200mm projection
- rectangular normal flow
- hole diameter 37 mm
- 1/2" connection
- max. flow 25.1 l/min at 3 bar flow pressure

	Brushed Chrome	13 801 670-93
	Chrome	13 801 670-00
	Brushed Platinum	13 801 670-06
	Dark Chrome	13 801 670-19
	Matte Black	13 801 670-33

13 801 670

mm [inches]

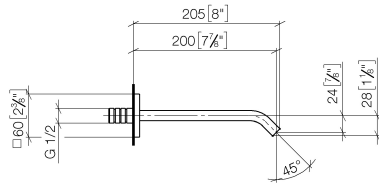

Flow rate chart

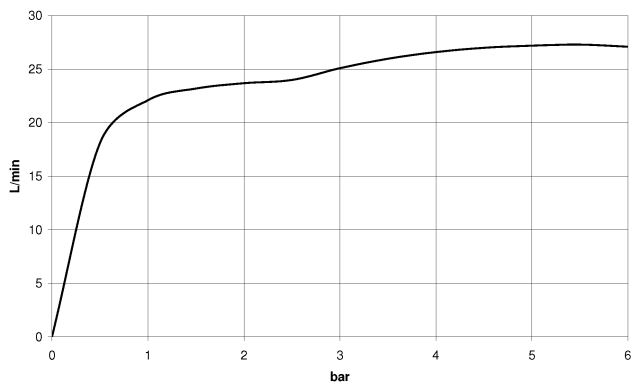

Certificates

IAPMO_4976 (2). WRAS_2005002.

13 801 670

Parts for other finishes can be found here: [Chrome](#)

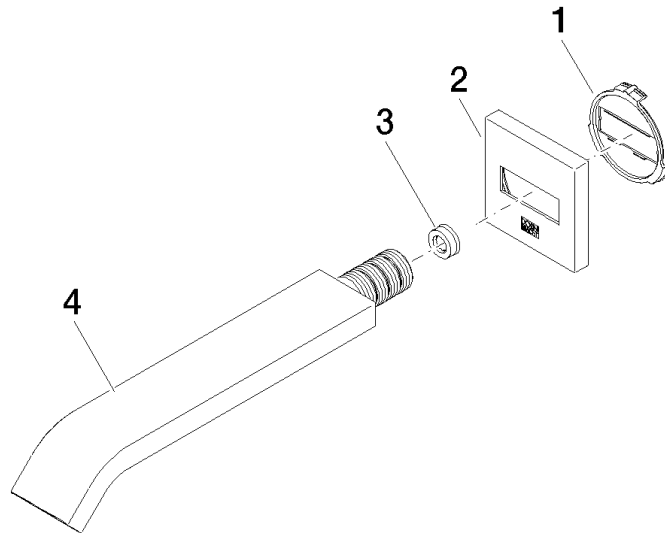

Spare parts list

No.	Item Number	Name	Quantity used	Delivery time
1	09 18 40 139 90	base	1	2
2	09 27 67 008-93	rosette	1	20
3	09 23 01 057 90	flow reducer	1	2
4	04 28 22 241 00-93	spout	1	20